

### GENERAL NOTES:

- ALL DIMENSIONS ARE FROM FACE OF STUD, OR FACE OF MASONRY, OR FACE OF CONCRETE WALL. ANY DIMENSIONS NOT SHOWN OR DEEMED QUESTIONABLE ARE TO BE VERIFIED BY ARCHITECT/DESIGNER. DO NOT SCALE DRAWINGS.
- PROVIDE WOOD BLOCKING SUPPORTS AS REQUIRED FOR ALL SURFACE MOUNTED ITEMS.
- COORDINATE WORK OF THIS TRADE WITH OTHER TRADES.
- PROVIDE MISCELLANEOUS SUPPORT FOR ALL CEILING SUSPENDED ITEMS.
- APPLY SEALANT AT ALL JUNCTURES BETWEEN DIFFERENT MATERIALS (I.E. WINDOWS AND CAST STONE).
- APPLY SEALANT AT ALL PLUMBING FIXTURES AT JUNCTURE WITH WALL.
- APPLY SEALANT AT ALL COUNTERTOPS AND BACK SPLASHES AT JUNCTURE WITH WALL.
- NON LOAD BEARING INTERIOR STUD WALLS TO BE 24" O.C., U.N.O. LOAD BEARING STUD WALLS TO BE 16" O.C. ALL WOOD STUDS ARE TO BE BRACED ACCORDING TO MANUFACTURER'S LIMITING HEIGHT L/240.
- ALL BEDROOM CLOSETS TO RECEIVE 2 ROWS OF CONTINUOUS 12" WIRE SHELVING WITH SLIDING HANGER ROD. MOUNT AT 3'-8" A.F.F. AND 7'-4" A.F.F.
- ALL HALLWAY AND BATH LINEN CLOSETS TO RECEIVE WALL TO WALL 12" WIRE SHELVING @ 16" O.C. UP TO 7'-4" A.F.F.
- REFER TO TR200 SERIES AND A300 SERIES SHEETS FOR TRUSS BEARING INFO.
- NOT USED.
- WINDOW NOTATION REFERS TO PGT WINGUARD SERIES SINGLE HUNG WINDOWS W/DOUBLE PANE INSULATED FRAME FINISH: BLACK ANODIZED ALUMINUM. WINDOWS NOTED AS SEGMENT WINDOWS ARE OPERABLE SEGMENT HEADS. WINDOWS NOTED AS EYEBROW ARE DIRECT SET PICTURE WINDOWS. WINDOW DESIGNATIONS ARE STATED IN FEET AND INCHES: I.E.: 4050 = 4'-0" WIDE X 5'-0" TALL A/W=AWNING OPENING TOP HINGED. F7=FIXED WINDOW. SH=SINGLE HUNG WINDOW. CA=CASEMENT WINDOW. HS=HORIZONTAL SLIDER WINDOW.
- ALL HARDWARE TO BE SCHLAGE SERIES-A OR BETTER
- ALL INTERIOR CLOSET DOORS TO BE HOLLOW CORE 6 PANEL WHITE, U.N.O. DOOR DESIGNATIONS ARE STATED IN FEET & INCHES: I.E.: 3068 = 3'-0" WIDE X 6'-8" TALL FRONT ENTRY DOOR TO BE SOLID METAL PTD.

### PLAN NOTES:

- ALIGN FINISH FACES.
- ELECTRIC METER LOCATION.
- ELECTRIC PANEL LOCATION.
- MAIN DISCONNECT LOCATION.
- A/C LOCATION.
- ATTIC ACCESS 24X48.
- GRANITE COUNTER TOPS
- REFRIGERATOR
- CARBAGE DISPOSAL UNDER SINK, PROVIDE POWER AS NEEDED.
- ISLAND COUNTERTOP @ 36" A.F.F. CENTER ISLAND CABINERY W/ GRANITE COUNTERTOP. (CABINERY BY OWNER)
- UNDER COUNTER DISHWASHER
- GAS GRILL W/EXHAUST HOOD
- UNDER COUNTER REFRIGERATOR.
- UNDER CABINET ROPE LIGHTING.
- BASE CABINETS & SHELF ABOVE
- COOK TOP RANGE W/ VENTED HOOD. (VERIFY BY OWNER)
- SHOWER CONTROLS.
- WALL TO WALL MIRROR WITH FRAME.
- 42" TALL X (WIDTH OF CABINET) MIRROR WITH FRAME.
- 20" WIDE OVAL MIRROR.
- GLASS DOOR & FRAMELESS SHOWER PANELS.
- NOT USED.
- MOVIE STORAGE.
- RCS RACK SYSTEM, (BY OTHERS)
- THEATER SCREEN, (BY OTHERS)
- SHelf ABOVE
- UNDERCOUNTER SHELVES
- BASE CABINETS & SHELVES ABOVE
- NOM. 4X4 P.T. POST
- NOM. 6X6 P.T. POST
- PLANT FOR "BOWLING BALL AND PINS" DISPLAY & HALL ENTRY ROOF (VERIFY DIMENSIONS & HT. W/ OWNER)
- PLANT SHELF FOR DOMINOES DISPLAY (VERIFY DIMENSIONS & HT. W/ OWNER)
- ICE-MAKER MACHINE W/ DRAIN
- COUNTERTOP @ 36" HT. (VERIFY DIMENSIONS & MATERIALS W/ OWNER)

### LEGEND:

- 3050 DH WINDOW LABEL = 3'-0" WIDE X 5'-0" TALL, DOUBLE HUNG
- 3068 DOOR LABEL = 3'-0" X 6'-8"
- DINING ROOM ROOM NAME
- NEW CMU WALL & GROUTED CELL - SEE DETAIL-A401.
- NEW INTERIOR NON-LOAD BEARING WALL
- NEW INTERIOR LOAD BEARING WALL
- LxX = LOTT'S OR WEKIWA CONCRETE PRODUCTS MARK NO.
- 2X4.2X6 LBM. NOM. 2X WOOD STUD INTERIOR LOAD BEARING WALL

### WIND INFORMATION:

PER 2017 FBC  
 1. ROOF LIVE LOAD = 20 PSF  
 2. ENCLOSED  
 3. POS/NEG PRESSURES:  
 INTERNAL (MIN) : 0.18  
 TRUSS B.C.L.L. : 10PD/PSF  
 ATTIC W/STOR. B.C.L.L. : 20 PSF  
 4. WIND VELOCITY:  
 BASIC WIND SPEED = 139 MPH  
 WIND EXPOSURE = B  
 PER ANSI/ASCE 7-10, FBC 2017 R301.2.1, #3

5. ROOF ZONE#1: -31.5/+16.82 PSF  
 ROOF ZONE#2: -53.96/+19.36 PSF  
 ROOF ZONE#3: -86.64/+21.18 PSF  
 6. RISK CATEGORY = II  
 7. FLOOD = N/A  
 8. SBV = 2,000 PSF COMPONENT/ CLADDING DESIGN  
 9. WIND PRESSURE = SEE SCHEDULE BELOW

DESIGN WIND PRESSURE FOR OPENINGS-PER FLORIDA BUILDING CODE FBC 2017 R301.2.1			
ZONE 4		ZONE 5	
10 SQFT	+30.4/-33.0	10 SQFT	+30.4/-40.7
20 SQFT	+29.0/-31.6	20 SQFT	+29.0/-38.0
50 SQFT	+27.2/-29.8	50 SQFT	+27.2/-34.3
100 SQFT	+25.9/-28.4	100 SQFT	+25.9/-31.6
500 SQFT	+22.7/-25.2	500 SQFT	+22.7/-25.2

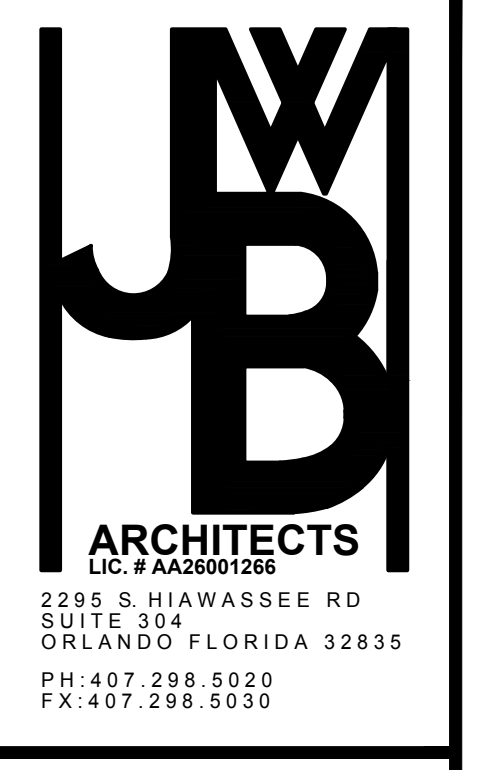

Owner:  
**ANDREW GREENSTEIN**

**1ST FLOOR PLAN**  
**GREENSTEIN RESIDENCE**  
 GREAT ESCAPE PARKSIDE RETREAT  
 E. REDWING RD.  
 GROVELAND, FL 34771

Architect of Record:  
 John W. Burl - AR9363

Revisions:		
Date:	Drawn By:	Checked By:
5/13/18	JMD	JWB
Project No.:		
18-012		
Sheet No.:		

A201

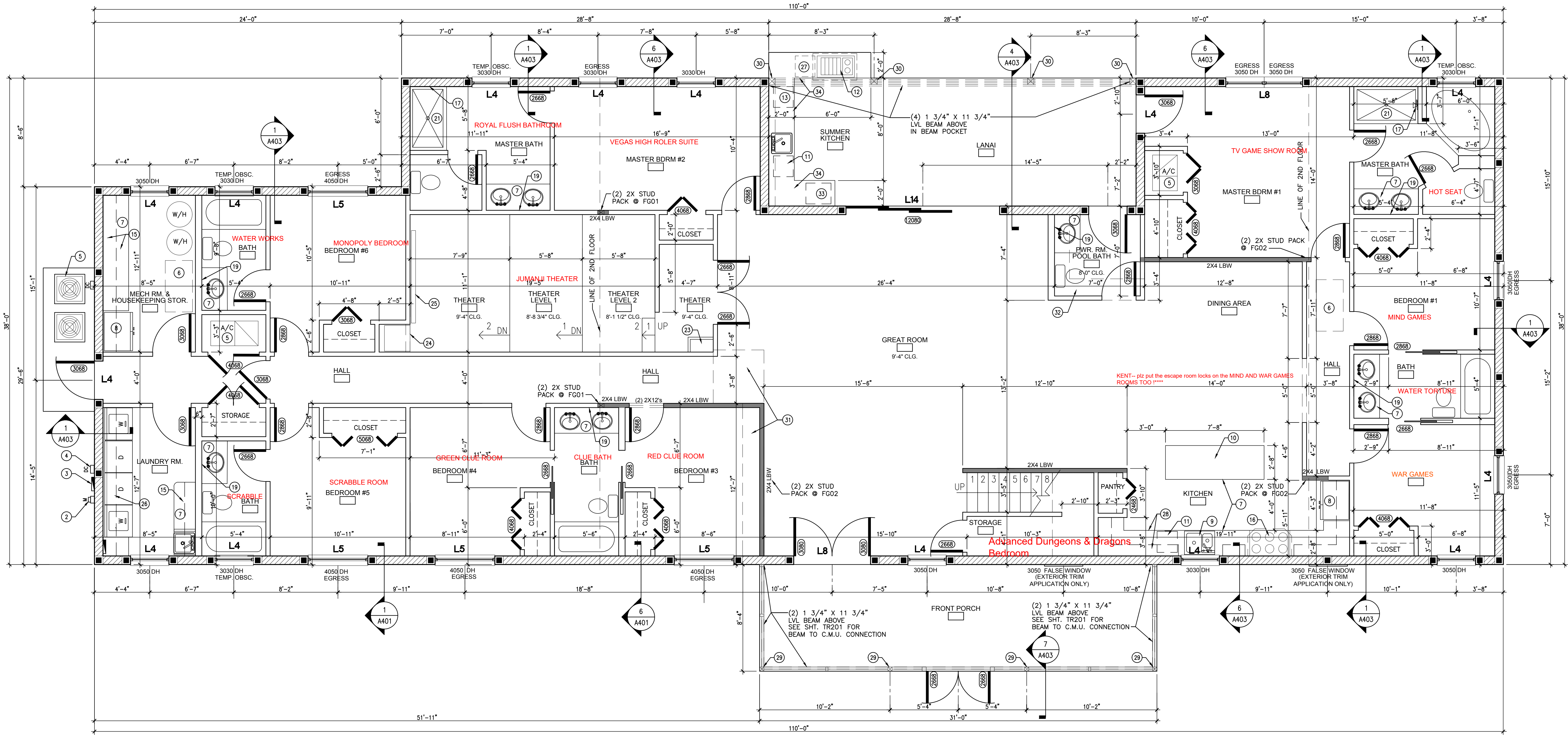

1 **1ST FLOOR PLAN**  
 SCALE: 1/4" = 1'-0"

**GENERAL NOTES:**

- A. ALL DIMENSIONS ARE FROM FACE OF STUD, OR FACE OF MASONRY, OR FACE OF CONCRETE WALL. ANY DIMENSIONS NOT SHOWN OR DEEMED QUESTIONABLE ARE TO BE VERIFIED BY ARCHITECT/DESIGNER. DO NOT SCALE DRAWINGS.
- B. PROVIDE WOOD BLOCKING SUPPORTS AS REQUIRED FOR ALL SURFACE MOUNTED ITEMS.
- C. COORDINATE WORK OF THIS TRADE WITH OTHER TRADES.
- D. PROVIDE MISCELLANEOUS SUPPORT FOR ALL CEILING SUSPENDED ITEMS.
- E. APPLY SEALANT AT ALL JUNCTURES BETWEEN DIFFERENT MATERIALS (I.E. WINDOWS AND CAST STONE).
- F. APPLY SEALANT AT ALL PLUMBING FIXTURES AT JUNCTURE WITH WALL.
- G. APPLY SEALANT AT ALL COUNTERTOPS AND BACK SPLASHES AT JUNCTURE WITH WALL.
- H. NON LOAD BEARING INTERIOR STUD WALLS TO BE 24" O.C., U.N.O. LOAD BEARING STUD WALLS TO BE 16" O.C. ALL WOOD STUDS ARE TO BE BRACED ACCORDING TO MANUFACTURER'S LIMITING HEIGHT L/240.
- I. ALL BEDROOM CLOSETS TO RECEIVE 2 ROWS OF CONTINUOUS 12" WIRE SHELVING WITH SLIDING HANGER ROD. MOUNT AT 3'-8" A.F.F. AND 7'-4" A.F.F.
- J. ALL HALLWAY AND BATH LINEN CLOSETS TO RECEIVE WALL TO WALL 12" WIRE SHELVING @ 16" O.C. UP TO 7'-4" A.F.F.
- K. REFER TO TR200 SERIES AND A300 SERIES SHEETS FOR TRUSS BEARING INFO.
- L. NOT USED.
- M. WINDOW NOTATION REFERS TO PGT WINGARD SERIES SINGLE HUNG WINDOWS W/DOUBLE PANE INSULATED. FRAME FINISH: BLACK ANODIZED ALUMINUM. WINDOWS NOTED AS SEGMENT WINDOWS ARE OPERABLE SEGMENT HEADS. WINDOWS NOTED AS EYEBROW ARE DIRECT SET PICTURE WINDOWS. WINDOW DESIGNATIONS ARE STATED IN FEET and INCHES: I.E.: 4050 = 4'-0" WIDE X 5'-0" TALL WIN=AWNING OPENING TOP HINGED. FX=FIXED WINDOW. SH=SINGLE HUNG WINDOW. CA=CASEMENT WINDOW. HS=HORIZONTAL SLIDER WINDOW.
- N. ALL HARDWARE TO BE SCHLAGE SERIES-A OR BETTER
- O. ALL INTERIOR CLOSET DOORS TO BE HOLLOW CORE 6 PANEL WHITE, U.N.O. DOOR DESIGNATIONS ARE STATED IN FEET & INCHES: I.E.: 3068 = 3'-0" WIDE X 6'-8" TALL FRONT ENTRY DOOR TO BE SOLID METAL PTD.

**PLAN NOTES:**

- ① ALIGN FINISH FACES.
- ② GRANITE COUNTER TOPS
- ③ WALL TO WALL MIRROR WITH FRAME.
- ④ 42" TALL X (WIDTH OF CABINET) MIRROR WITH FRAME.
- ⑤ GLASS DOOR & FRAMELESS SHOWER PANELS.
- ⑥ CARNIVAL BOOTH PARTITIONS, (BY OWNERS).
- ⑦ HAZER SHELF LOCATION (SEE CONSTRUCTION SPECS.).
- ⑧ HAZER MOUNTED ON LASER SHELF.
- ⑨ EXCITEMENT STROBE & MISSION CLOCK..
- ⑩ LASER CONTROL STATION MOUNTED @ 6'-0" A.F.F.
- ⑪ ARM START SWITCH.
- ⑫ ALUMINUM GUARDRAIL & RAILING SYSTEM
- ⑬ ATTIC ACCESS 24"x48"

**LEGEND:**

- 3050 DH WINDOW LABEL = 3'-0" WIDE X 5'-0" TALL, DOUBLE HUNG
- ③068 DOOR LABEL = 3'-0" X 6'-8"
- DINING ROOM ROOM NAME
- NEW CMU WALL & GROUDED CELL - SEE DETAIL-A401.
- NEW INTERIOR NON-LOAD BEARING WALL
- NEW INTERIOR LOAD BEARING WALL
- LxX = LOTT'S or WEKMA CONCRETE PRODUCTS MARK NO.
- 2x4.2x6 LBW NOM. 2X WOOD STUD INTERIOR LOAD BEARING WALL

**WIND INFORMATION:**

- PER 2017 FBC
- 1. ROOF LIVE LOAD = 20 PSF
- 2. ENCLOSED
- 3. POS/NEG PRESSURES: INTERNAL (MIN) : 0.18 TRUSS B.C.L.L. : 10PD/PSF ATTIC W/STOR. B.C.L.L. : 20 PSF
- 4. WIND VELOCITY: BASIC WIND SPEED = 139 MPH WIND EXPOSURE = B PER ANSI/ASCE 7-10, FBC 2017 R301.2.1, #3
- 5. ROOF ZONE#1: -31.5/+16.82 PSF
- 6. ROOF ZONE#2: -53.96/+19.36 PSF
- 7. ROOF ZONE#3: -86.64/+21.18 PSF
- 8. RISK CATEGORY = II
- 9. FLOOD = N/A
- 10. SBV = 2,000 PSF COMPONENT/ CLADDING DESIGN
- 11. WIND PRESSURE = SEE SCHEDULE BELOW

DESIGN WIND PRESSURE FOR OPENINGS-PER FLORIDA BUILDING CODE FBC 2017 R301.2.1			
ZONE 4		ZONE 5	
10 SQFT	+30.4/-33.0	10 SQFT	+30.4/-40.7
20 SQFT	+29.0/-31.6	20 SQFT	+29.0/-38.0
50 SQFT	+27.2/-29.8	50 SQFT	+27.2/-34.3
100 SQFT	+25.9/-28.4	100 SQFT	+25.9/-31.6
500 SQFT	+22.7/-25.2	500 SQFT	+22.7/-25.2

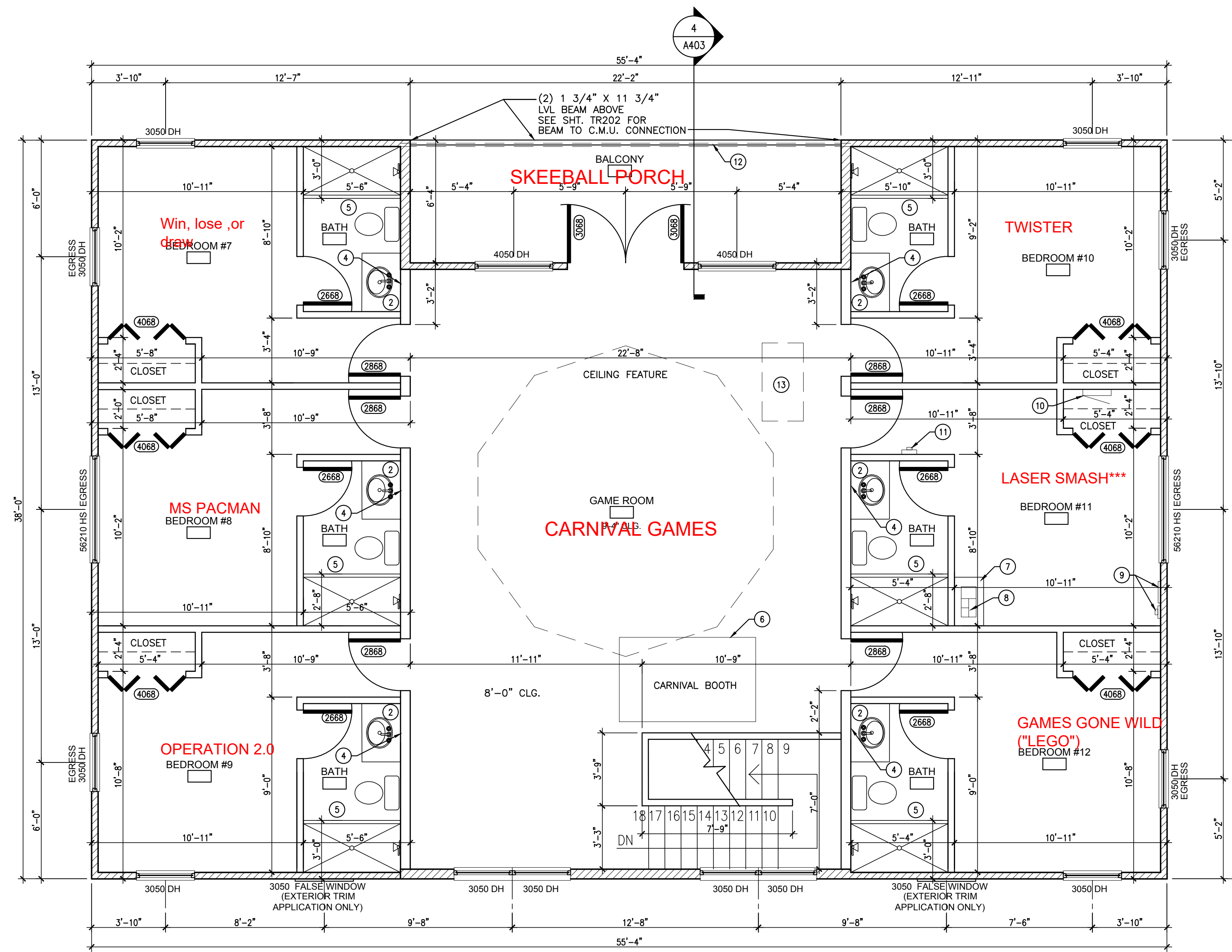

1 **2ND FLOOR PLAN**  
 SCALE: 1/4" = 1'-0"



Owner:  
**ANDREW GREENSTEIN**

2ND FLOOR PLAN

GREENSTEIN RESIDENCE

GREAT ESCAPE PARKSIDE RETREAT  
E. REDWING RD.  
GROVELAND, FL 34711

Architect of Record:  
John W. Burt - ARB9963

Revisions:		
Date:	Drawn By:	Checked By:
5/13/18	JMD	JWB
Project No. 18-012		
Sheet No.		

A202